

# Installation & Maintenance Instructions

2-WAY INTERNAL PILOT-OPERATED SOLENOID VALVES  
NORMALLY CLOSED OPERATION - 3/4", 1", 1 1/4", 1 1/2" OR 2" NPT  
FUEL GAS SERVICE

SERIES

8214

Form No. V7465—Sec. 2  
(Section 2 of 2)

NOTICE: See separate solenoid installation and maintenance instructions for information on: Wiring, Solenoid Temperature, Causes of Improper Operation, and Solenoid Replacement.

For instructions and exploded views, see Form No. V7465 Section 1.

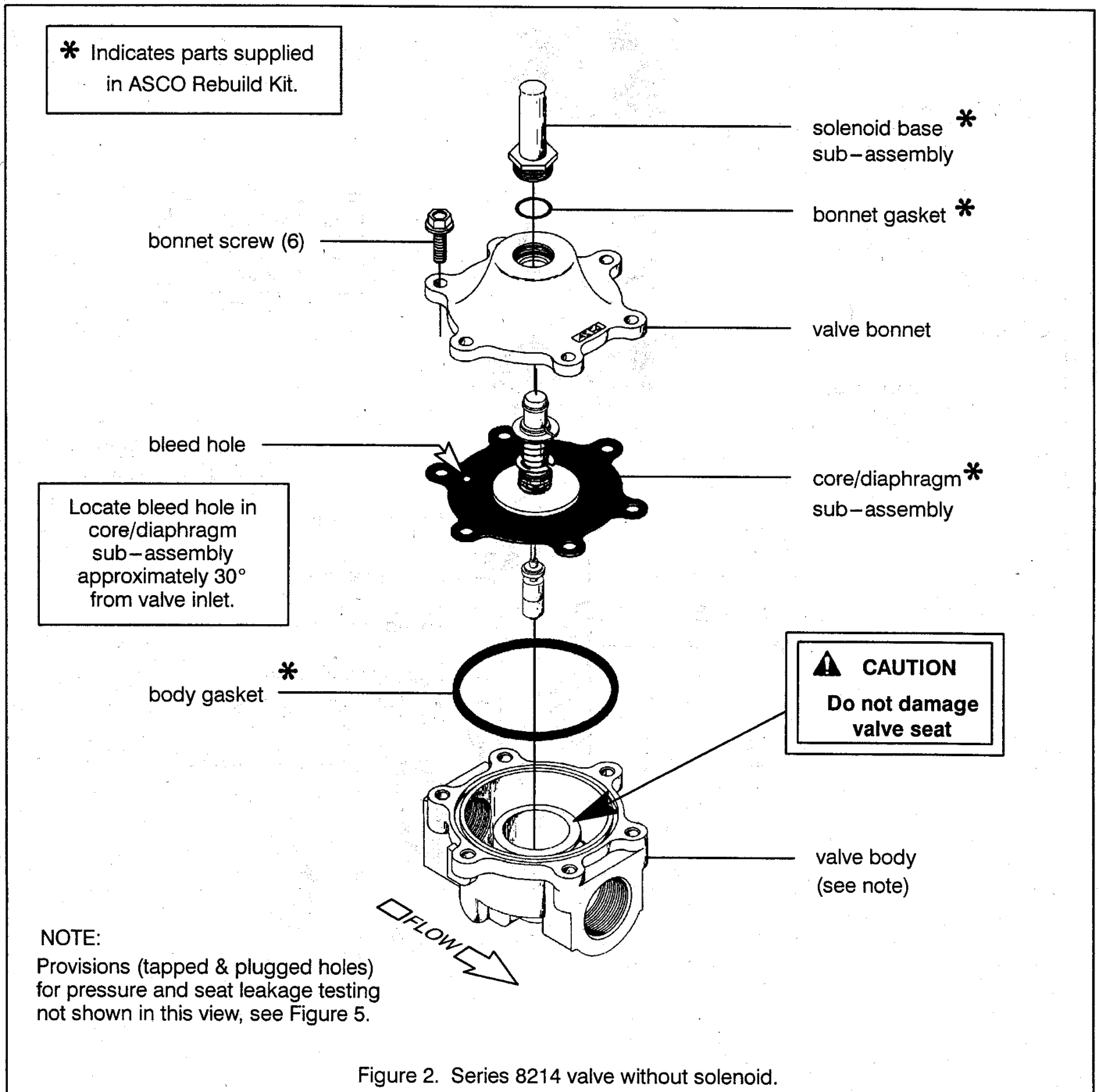

Figure 2. Series 8214 valve without solenoid.

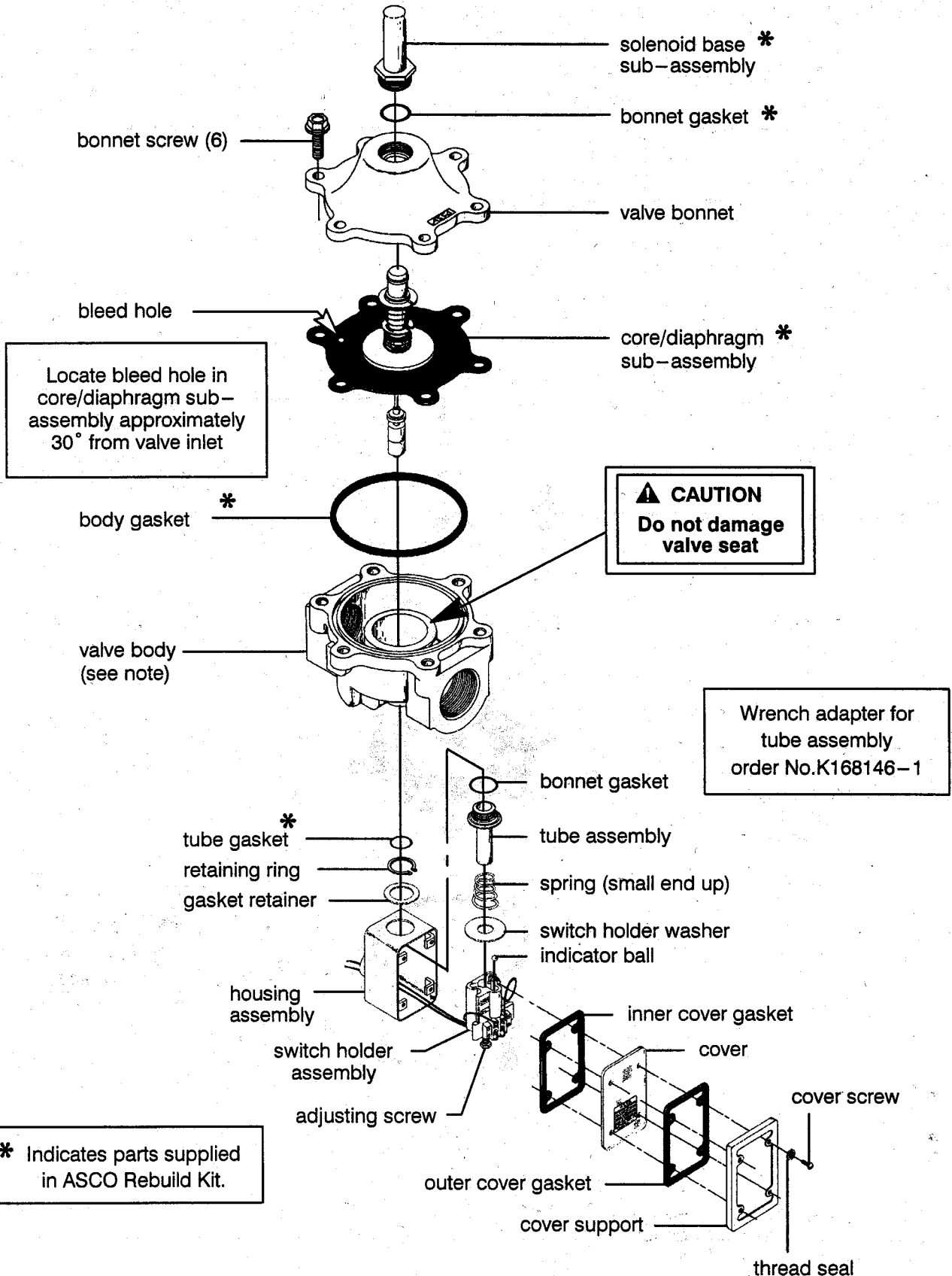
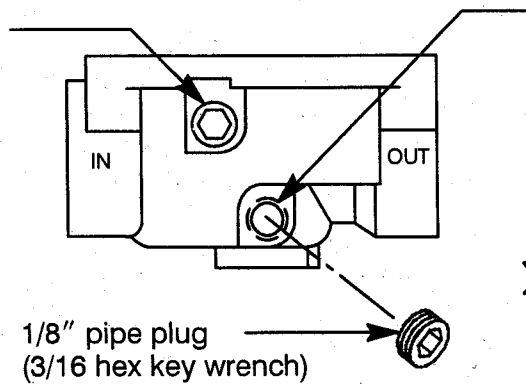

Figure 3. Series 8214 with electrical and visual position indicator.

**Partial side view of valve body showing location of tapped and plugged holes for pressure and seat leakage testing**

Lower two tapped and plugged holes on either side of valve body are for downstream seat leakage testing



Upper two tapped and plugged holes on either side of valve body are for upstream pressure testing



Figure 4. Provisions for pressure and seat leakage testing.

**To illustrate leakage testing only. Not for system layout.**

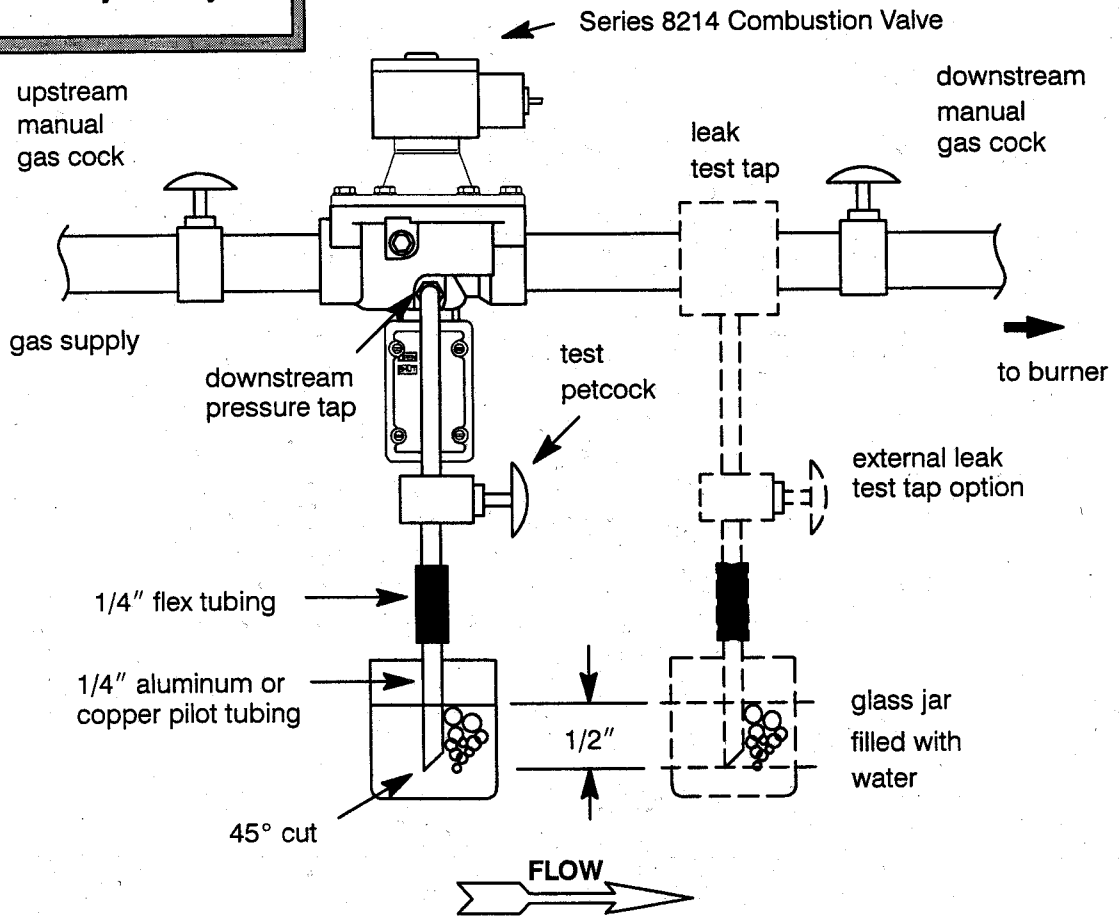

Figure 5. Testing for internal seat leakage.