

# Round Balancing Damper

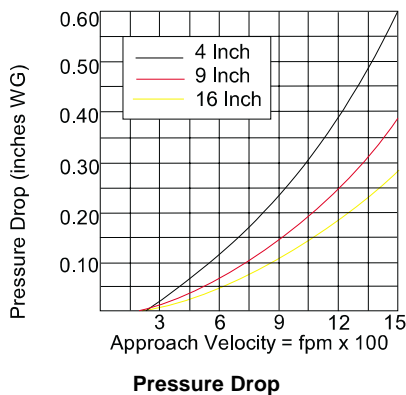

Round Balancing Damper



## Description

Johnson Controls provides top quality round dampers to control air flow in Heating, Ventilating, and Air Conditioning (HVAC) systems that fit standard round ducts.

The round damper has no seals for use in applications not requiring complete closure of the damper.

Johnson Controls round dampers have no components that require routine scheduled maintenance.

applications and are easily installed in round ducts.

Round balancing dampers are available with a factory-installed manual locking quadrant.

## Accessories

Refer to *Damper Accessory Kits* and *Damper Replacement Parts*.

## Features

- 20-gauge G90 galvanized sheet steel shroud
- 20-gauge 304 stainless steel shroud
- formed shroud which allows easy insertion into ductwork
- one-piece construction that increases rigidity and strength
- optional factory-installed manual locking quadrant that reduces installation time

## Applications

Round balancing dampers are available without seals for use in balancing or bypass

## To Order

Select round balancing dampers using *Damper System Building Blocks* as detailed in the selection chart.

## Selection Chart — Round Damper

|                     | Code Number   | R | B |  |  |  |  |  |  |
|---------------------|---|---|---|--|--|--|--|--|--|
| <b>Product Type</b> | R = Round Dampers   |   |   |  |  |  |  |  |  |
| <b>Application</b>  | B = Balancing - No Seals  |   |   |  |  |  |  |  |  |
| <b>Materials</b>    | G = Galvanized<br>S = Stainless Steel   |   |   |  |  |  |  |  |  |
| <b>Diameter</b>     | Galvanized: 04 to 22 - 1 Inch Increments<br>Stainless: 06 to 22 - 1 Inch Increments |   |   |  |  |  |  |  |  |
| <b>Actuator</b>     | B = Bracket, no actuator<br>M = Manual Locking Quadrant<br>N = None                 |   |   |  |  |  |  |  |  |

Example: An 8-inch balancing damper without quadrant is RGB08N.

## Construction

| Part                        | Construction  |
|-----------------------------|---|
| <b>Shroud</b>               | 20-gauge G90 galvanized sheet steel<br>20-gauge 304 Stainless Steel   |
| <b>Blade</b>                | 16-gauge 4 to 8" diameter G90 galvanized or 304 Stainless Steel, single-piece<br>9 - 22 inch (229 - 406 mm) diameter;<br>12-gauge G90 galvanized or 304 Stainless Steel, single-piece |
| <b>Shaft</b>                | 5/16 (1/2 inch adaptor provided when ordered without actuator) or 1/2 inch diameter galvanized or stainless steel, determined by diameter   |
| <b>Washer</b>               | Nylon   |
| <b>Bracket and Quadrant</b> | Galvanized steel  |

## Dimensions Without Actuator, in. (mm)

| A        | B           | C           |
|----------|-------------|-------------|
| 4 (102)  | 6 (152)     | 5.63 (143)  |
| 5 (127)  | 6 (152)     | 6.63 (168)  |
| 6 (152)  | 6 (152)     | 7.63 (194)  |
| 7 (178)  | 6.75 (171)  | 8.63 (219)  |
| 8 (204)  | 7.75 (197)  | 9.63 (244)  |
| 9 (229)  | 9.75 (248)  | 11.69 (297) |
| 10 (254) | 9.75 (248)  | 12.69 (322) |
| 12 (305) | 11.75 (298) | 14.69 (373) |
| 14 (356) | 14 (356)    | 16.69 (424) |
| 16 (406) | 16 (406)    | 18.69 (475) |

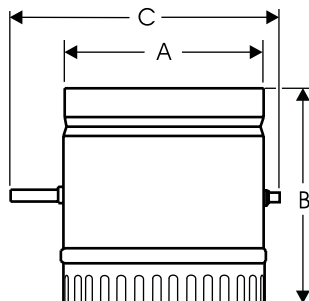

## Performance Data

| Round Balancing Damper                  |  |                     |
|---|--|---------------------|
| Actuator Torque<br>Required for Closing | 4- to 8-inch diameter dampers - 5 in-lb minimum    |                     |
|   | 9- to 22-inch diameter dampers - 15 in-lb minimum  |                     |
|   | 17- to 22-inch diameter dampers - 25 in-lb minimum |                     |
| Leakage Rate (cfm/sq ft)                | Not rated  |                     |
| Temperature Limits                      | Galvanized: -20 to 200°F (-29 to 93°C)             |                     |
|   | Stainless: -20 to 350°F (-29 to 177°C)             |                     |
| Approximate Weight                      | Size, inch (mm)                                    | Galvanized, lb (kg) |
|   | 4 (102)  | 1.1 (0.5)           |
|   | 8 (204)  | 2.9 (1.32)          |
|   | 12 (305)   | 8.0 (3.63)          |
|   | 16 (406)   | 14.0 (6.35)         |