

## Application

The AV-352 valve linkage is used to field-install gear train actuators on specified 2-1/2 to 6 in. valve bodies.

Features:

- Compatible with Invensys (Barber-Colman) 2-1/2 to 6 in. valves.
- Provides increased close-off pressure on 2-1/2 to 4 in. valves.
- Required for rated close-off pressure on 5 and 6 in. valves.

## Specifications

- Actuator mounting: In any upright position with actuator above the center line of the valve body.
- Minimum actuator torque required: 220 lb-in.
- Actuator travel required: 180°.

AV-352

## Gear Train Actuator Valve Linkage

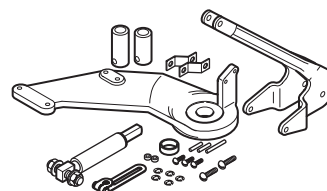

## Application

For assembling MP-9000 Series gear train actuators to 4 to 6 in. VB-9213 and VB-9313 valve bodies.

## Specifications

- Actuator mounting: In any upright position with actuator above the center line of the valve body.

AV-357, AV-358

## Electric/Electronic Valve Linkage Kits

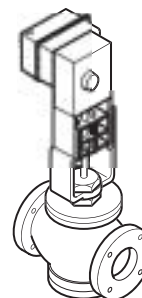

## Application

The AV-400 valve linkage kit is used to field-install MK-2690 pneumatic actuators to a variety of 1/2 through 2 in. valve bodies.

Features:

- Springs are provided for all control signal applications, including 3 to 7, 5 to 10, and 8 to 13 psig.
- Kit fits both current and obsolete Invensys (Barber-Colman) valve bodies.
- Contains parts for either VB-9XXX or VB-7XXX valve bodies.

## Specifications

- Actuator mounting: In any upright position with actuator above the center line of the valve body.

AV-400

## Pneumatic Actuator Valve Linkage Kit

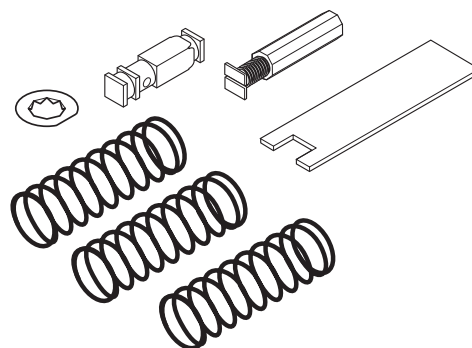

Spring Range psig (kPa)	Spring Color
3 to 7 (21 to 46)	Yellow
5 to 10 (34 to 69)	Black
8 to 13 (55 to 90)	Blue