

Application

For assembling pneumatic actuators to 2-1/2 to 6 in. valve bodies.

Specifications

- Actuator mounting: In any upright position with actuator above the center line of the valve body.

Linkage Number	Valve Body Sizes Except VB-9323	Actuator
AV-496	2-1/2 to 6 in.	MK-88XX MK-89XX

AV-496

Pneumatic Valve Linkage Kit

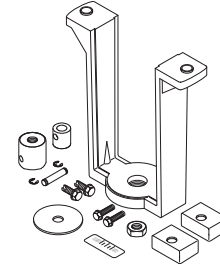

Application

For assembling MA-521X, MF-5X13, MP-521X, MP-541X, MP-551X, MPR-561X, MPR-571X, and MPR-581X Series hydraulic actuators to (1/2 to 2 in.) VB-7XXX and obsolete VB-9XXX valve bodies. Device consists of spring retainer, spring and combination stem extension and lock nut. TOOL-19 spring compression tool is recommended for assembly.

Specifications

- Actuator mounting: In any upright position above the center line of the valve body. For steam applications only, mount the actuator above the valve body at 45° from vertical.
- Contains parts for either VB-9XXX or VB-7XXX valve bodies.

AV-600

Electric/Electronic Valve Linkage Kit

