

# High Water Cut-Offs – Electronic For Steam Boilers

**NEW**

## Model 750-HW-MT-120

The 750-HW-MT-120 control provides continuous protection against a **HIGH WATER** condition in steam boilers and other water level applications. It can be wired to provide alarm, turn off burner or turn off feedwater pumps when a **HIGH WATER** condition occurs. The manual reset function will require the unit be reset after water has dropped below the level of the probe.

- For commercial or industrial applications
- Green LED power indicating light
- Red LED **HIGH WATER** indicating light
- Manual reset
- Test switch
- 20,000 ohms sensitivity
- NEMA 1 enclosure
- Maximum ambient temperature 120°F (49°C)

### Ordering Information

(Remote sensor must be ordered separately (see page 82-85))

Model Number	Part Number	Description	Weight lbs. (kg)
750-HW-MT-120	176236	Manual reset	2 (.9)

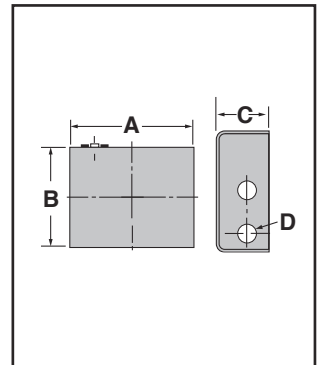

### Electrical Ratings

Voltage	Motor Switch Rating (Amperes)		Pilot Duty
	Full Load	Locked Rotor	
120 VAC	7.2	43.2	125 VA at 120 or 240 VAC 50 or 60 Hz
240 VAC	3.6	21.6	

### Dimensions, in. (mm)

A	B	C	D
6 <sup>3</sup> / <sub>8</sub> (162)	5 <sup>1</sup> / <sub>8</sub> (130)	2 <sup>9</sup> / <sub>16</sub> (65)	3/4 (20)