



Hawkeye® 500 Series

Field Mount Fractional HP Motor Control Device

U.S Patent No. 431,534



The **500 Series** combines an industrial grade load switching relay, current status switch and Hand-Off-Auto (HOA) switch in an easy to install remote enclosure making the series ideal for monitoring, directly controlling, and troubleshooting the control wiring of fractional horsepower motors.

The relay, current sensor, and HOA switch are combined in a series circuit. Once a 500 is wired in series between the power source and motor, all three components are installed. The housing provides physical separation and multiple wiring exits to isolate control and high voltage wiring. A 500 can be mounted directly on 2- or 4- gang junction boxes, nipped to a field enclosure, or stand alone.

APPLICATIONS

- Monitoring status of and controlling small motor loads which are not driven by a motor starter or contactor
 - Exhaust fans
 - Unit ventilators
 - Fan terminal units
 - Fan coil units
 - Recirculating pumps

Remote mounted current status sensor and command relay with or without HOA switch

- Combines status sensor, command relay and HOA switch in a single series circuit...one line connection for three devices
- Remote mounted enclosure eliminates the need to cram multiple devices into a junction box
- HOA provides true relay control...ideal for troubleshooting control wiring

Rated for a wide range of fractional HP motor applications

- All models rated up to 1HP@120VAC, NS Versions 1HP@120VAC and 1.5HP@277VAC... one product for all fractional HP motor control and status applications

Easy flexible installation

- Mounts directly on single or double gang boxes, flush to existing enclosures or stand alone...maximum installation flexibility



ORDERING INFORMATION

MODEL	AMP RANGE	STATUS OUTPUT	RELAY CONTACT RATING	RELAY COIL	HOA SWITCH	ADJUST SETPOINT	SENSOR CALIBRATION LEDS	RELAY POWER LED
H535	20A	Relay Only	N.O./N.C. (SPDT) 1HP@120VAC	24VAC/DC 36mA nom.	●			●
H535NS	20A	Relay Only	N.O./N.C. (SPDT) 1HP@120VAC 1.5HP@277VAC/DC	24VAC/DC 36mA nom.				●
H540	0.25-20A	N. O., Solid State 1.0A@30VAC/DC*	N.O./N.C. (SPDT) 1HP@120VAC	24VAC/DC 36mA nom.	●			●
H540NS	0.25-20A	N. O., Solid State 1.0A@30VAC/DC	N.O./N.C. (SPDT) 1HP@120VAC 1.5HP@277VAC/DC	24VAC/DC 36mA nom.				●
H548	0.5-20A	N. O., Solid State 1.0A@30VAC/DC	N.O./N.C. (SPDT) 1HP@120VAC	24VAC/DC 36mA nom.	●	●	●	●
H548NS	0.5-20A	N. O., Solid State 1.0A@30VAC/DC	N.O./N.C. (SPDT) 1HP@120 VAC 1.5HP@277VAC/DC	24VAC/DC 36mA nom.		●	●	●



APPLICATION/WIRING EXAMPLE

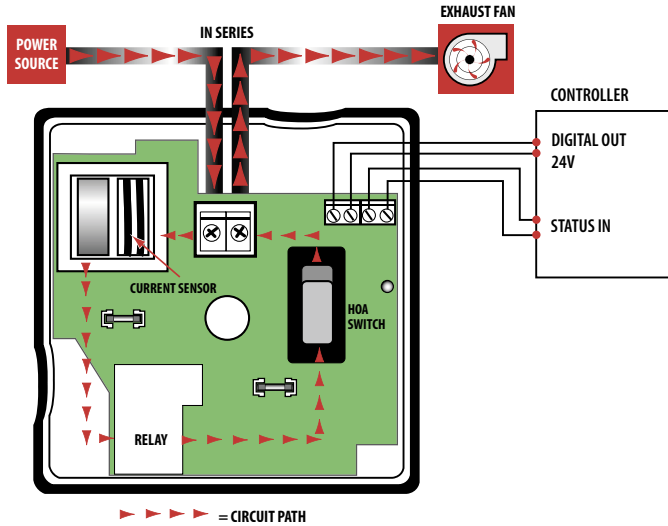

DIMENSIONAL DRAWINGS

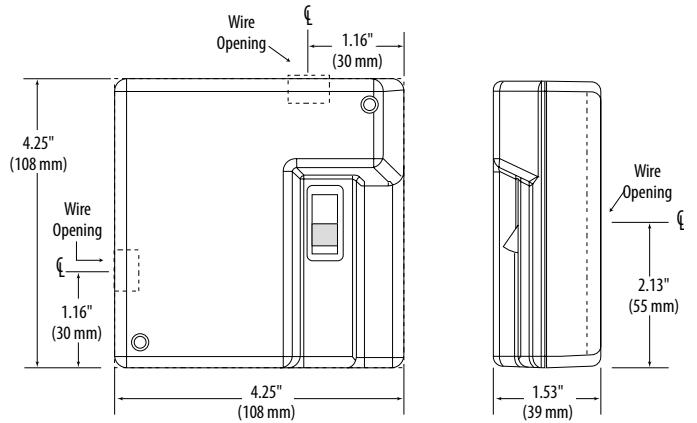

MOUNTING OPTIONS

Mounts directly on 4-gang junction box

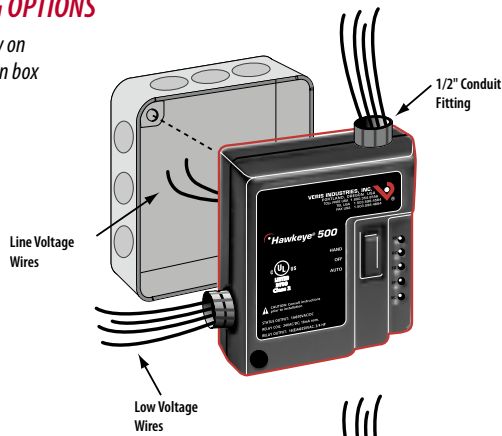

Mounts directly on 2-gang junction box

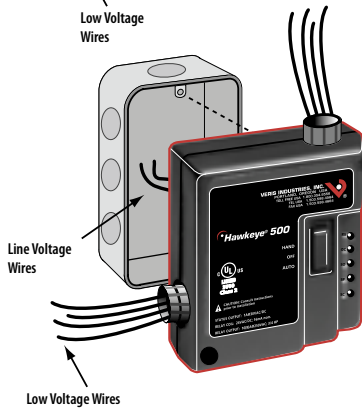

Mounts directly on wall or panel

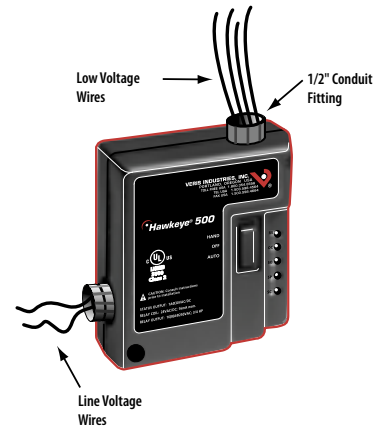

Enclosure Mount

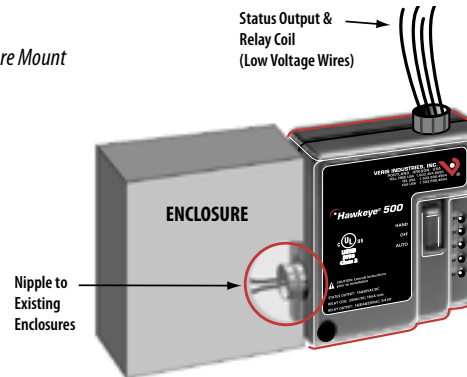

SPECIFICATIONS

Sensor Power	Induced
Max. Operating Voltage (H535NS, H540 & H548 Models)	120VAC
Max. Operating Voltage (H535, H540NS & H548NS Models)	120-277VAC
Frequency Range	50/60Hz.
Trip Setpoint (H540 Models)	Fixed (0.25A)
Trip Setpoint (H548 Models)	Adjustable (0.5-20A)
Humidity Range	0 - 95% non-condensing
Amperage Range (H540 & H540NS Models)	0.25-20A
Amperage Range (H548 & H548NS Models)	0.5-20A
Temperature Range	-15° to 60°C
Relay Coil	24VAC/DC@36mA nominal
Status Output	1.0A@30VAC/DC

Do not use the LED status indicators as evidence of applied voltage.